

NOTICE - This drawing is a part of the proprietary and/or confidential information of the manufacturer. It is to be used only for the purpose of the contract under which it was prepared. It is to be returned to the manufacturer upon completion of the contract. It is to be destroyed under a written agreement with the manufacturer. It is not to be reproduced, copied, or disseminated in any form without the prior written consent of the manufacturer.

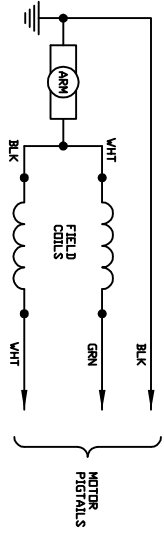

SCHEMATIC REF

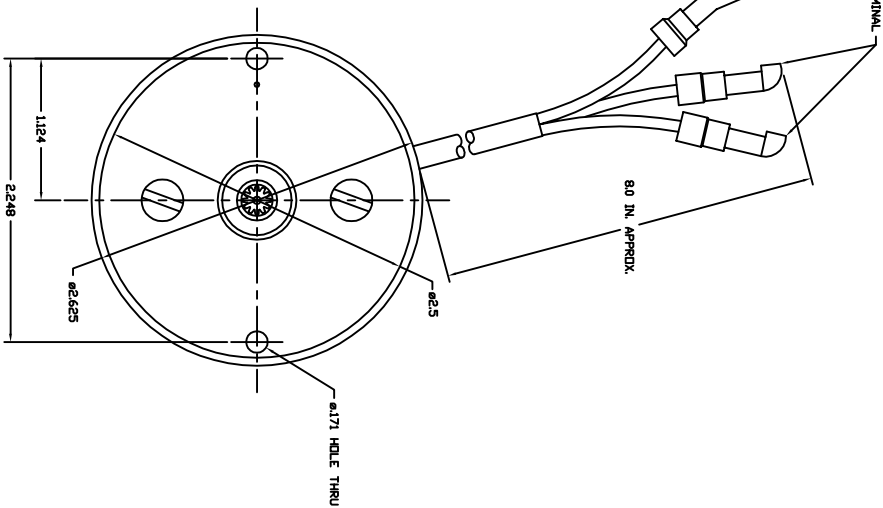
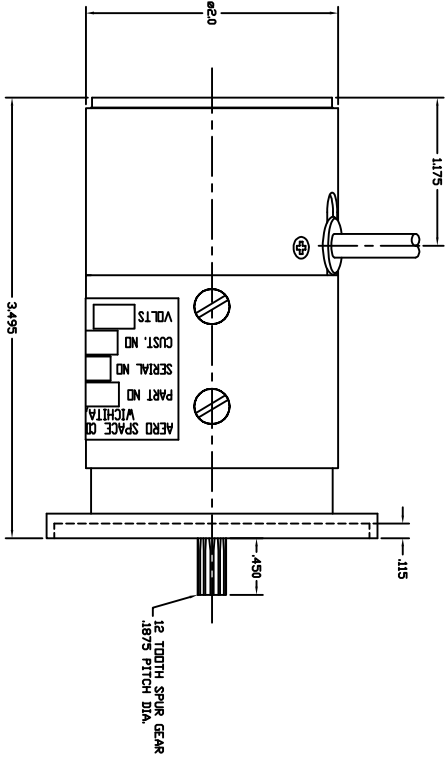

NOTES CONT'D.

- 7. FLAP MOTOR SHALL HAVE THE FOLLOWING LIMITS (CV & CCV):
- A. MINIMUM SPEED - 1100 RPM, MIN.
- B. NO LOAD RPM - 22,200 RPM, MIN.
- C. NO LOAD CURRENT - 4 AMPS, MAX.
- D. STALL TORQUE - 122 IN. OZ. MIN.
- E. STALL CURRENT - 122 IN. OZ. MIN.
- F. AT 64 IN. OZ. TORQUE - 13 AMPS, MAX., 5180 RPM, MIN.

REV	DATE	DESCRIPTION	BY	CHKD	APP'D
1					

DESIGN	7701-001	FINAL
DRAWN		
CHECKED		
APPROVED		

INTENDED FOR USE	FLIGHT
DESIGNATION	7701-001
DATE	5-6-79
BY	DI SHOWN
CHKD	
APP'D	

SCALE	2:1
UNIT	IN
SHEET	1 OF 1

CA. NO.	REV.	REVISION DESCRIPTION	DATE	APP.
AS31878	A	DELETED TORQUE CURVE	5-21-01	J.S.

REV	DATE	DESCRIPTION	BY	CHKD	APP'D
1					

DESIGN	7701-001	FINAL
DRAWN		
CHECKED		
APPROVED		

INTENDED FOR USE	FLIGHT
DESIGNATION	7701-001
DATE	5-6-79
BY	DI SHOWN
CHKD	
APP'D	

SCALE	2:1
UNIT	IN
SHEET	1 OF 1